

Property Measurements

Parcel				
Legal:	Parcel No.:			
Property Address: 115 Starmount Dr				
City: Kings Mountain	County: Cleveland	State: NC	ZipCode: 28086	
Owner:				
:				
Measurer: Square Up Measuring		Inspection Date: 05/05/2024		

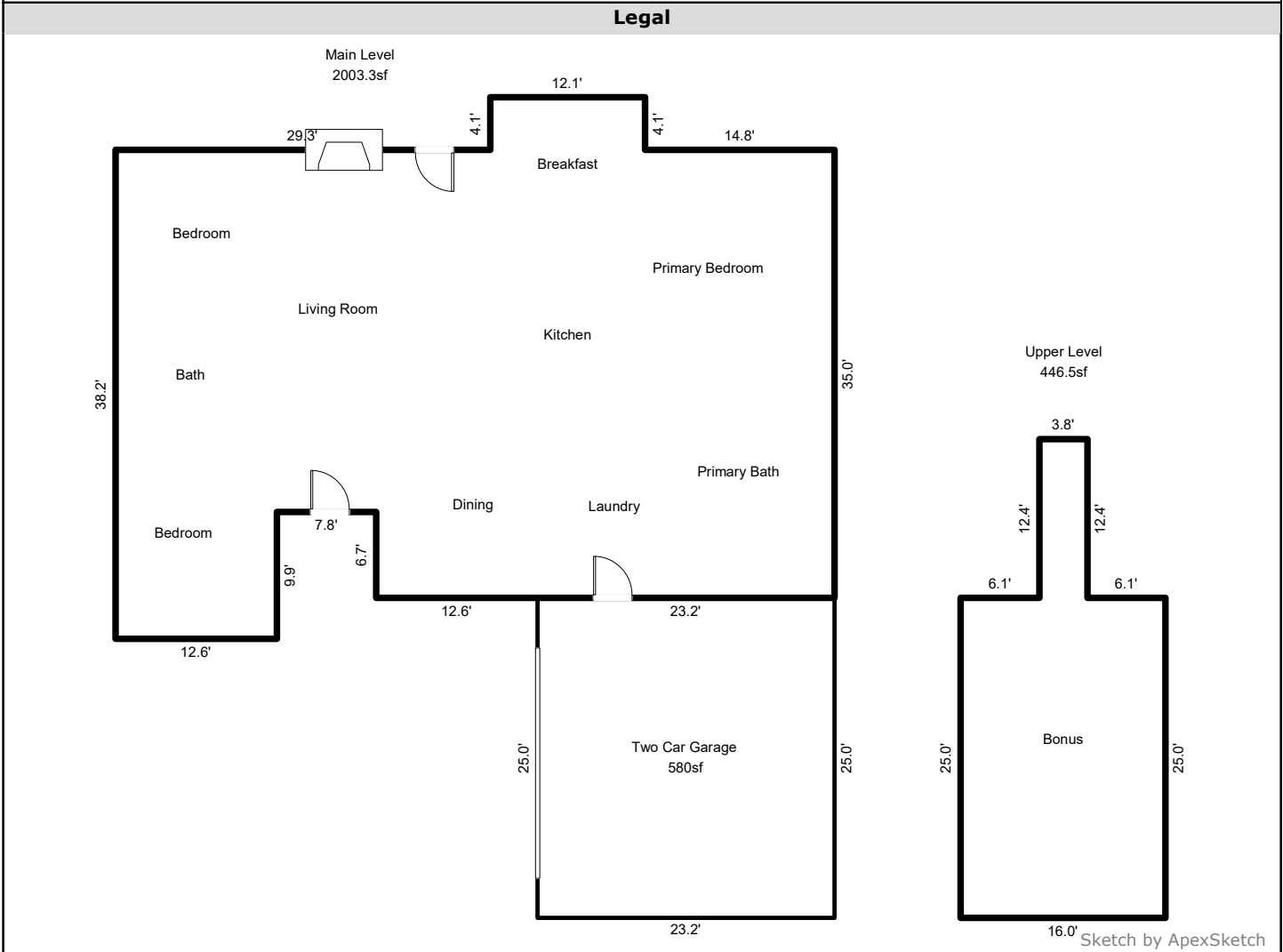

AREA CALCULATIONS SUMMARY					
Code	Description	Factor	Net Size	Perimeter	Net Totals
GLA1	Main Level	1.0	2003.3	210.3	2003.3
GLA2	Upper Level	1.0	446.5	106.8	446.5
GAR	Two Car Garage	1.0	580.0	96.4	580.0
Net LIVABLE		cnt	2	(rounded)	2,450

COMMENT TABLE 1	
<p>For a more accurate measurement, measurements are based on the Official ANSI Z765-2021 Handbook and the current North Carolina Residential Square Footage Guideline approved by the American National Standards Institute (ANSI) and recognized by the North Carolina Real Estate Commission for single-family dwellings, townhouses and condos for both North and South Carolina. Measurements for marketing and informational purposes.</p> <ul style="list-style-type: none"> • Doors, stairs and fireplace locations are approximate. • Room locations are approximate. • All measurements are rounded to the nearest tenth of an inch. 	
COMMENT TABLE 2	COMMENT TABLE 3

Property Measurements

Parcel

Legal: Parcel No.:
Property Address: 115 Starmount Dr
City: Kings Mountain County: Cleveland State: NC ZipCode: 28086
Owner:
:
Measurer: Square Up Measuring Inspection Date: 05/05/2024

Legal

Main Level (GLA1)

12.10 x 4.10 = 49.61
35.00 x 12.60 = 441.00
28.30 x 20.35 = 575.91
35.00 x 23.20 = 812.00
12.60 x 9.90 = 124.74
Total area: 2003.26

Two Car Garage (GAR)

25.00 x 23.20 = 580.00
Total area: 580.00

Upper Level (GLA2)

12.40 x 3.75 = 46.50
25.00 x 16.00 = 400.00
Total area: 446.50