

Property Measurements

Parcel				
Legal:	Parcel No.:			
Property Address: 438 S Wilson St				
City: Rock Hill	County: York	State: SC	ZipCode: 29730	
Owner:				
:				
Measurer: Square Up Measuring		Inspection Date: 07/12/2024		

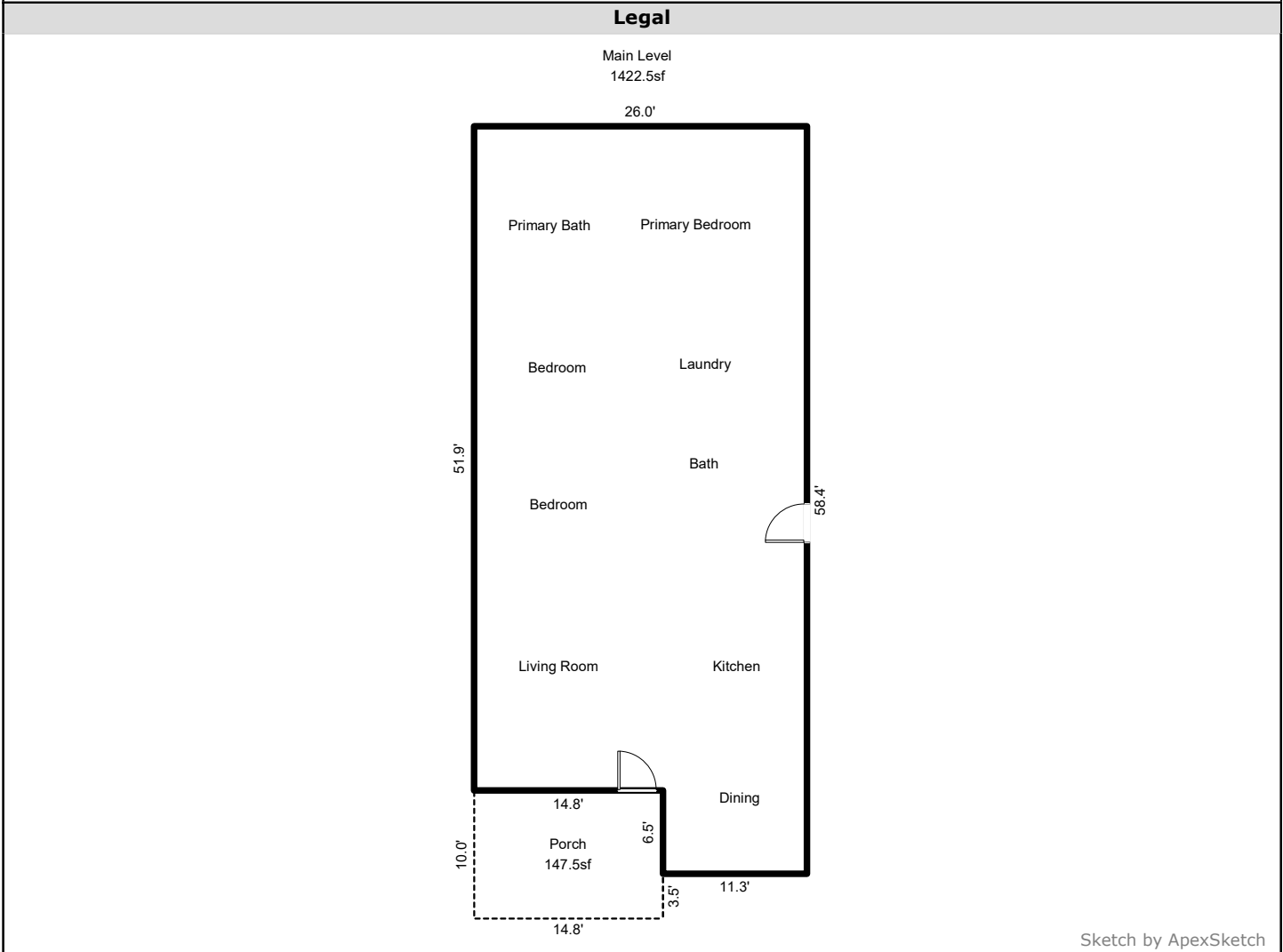

AREA CALCULATIONS SUMMARY					
Code	Description	Factor	Net Size	Perimeter	Net Totals
GLA1	Main Level	1.0	1422.5	168.8	1422.5
P/P	Porch	1.0	147.5	49.5	147.5
Net LIVABLE					
	cnt	1	(rounded)		1,423

COMMENT TABLE 1	
<p>For a more accurate measurement, measurements are based on the Official ANSI Z765-2021 Handbook and the current North Carolina Residential Square Footage Guideline approved by the American National Standards Institute (ANSI) and recognized by the North Carolina Real Estate Commission for single-family dwellings, townhouses and condos for both North and South Carolina. Measurements for marketing and informational purposes.</p> <ul style="list-style-type: none"> Doors, stairs and fireplace locations are approximate. Room locations are approximate. All measurements are rounded to the nearest tenth of an inch. <div style="text-align: right; margin-top: 10px;"> </div>	
COMMENT TABLE 2	COMMENT TABLE 3

Property Measurements

Parcel

Legal: Parcel No.:
Property Address: 438 S Wilson St
City: Rock Hill County: York State: SC ZipCode: 29730
Owner:
:
Measurer: Square Up Measuring Inspection Date: 07/12/2024

Legal

Main Level (GLA1)

58.40 x 11.25 = 657.00
51.90 x 14.75 = 765.53
Total area: 1422.53

Porch (P/P)

14.75 x 6.50 = 95.87
14.75 x 3.50 = 51.63
Total area: 147.50