

Property Measurements

Parcel				
Legal:	Parcel No.:			
Property Address: 220 High St				
City: Rock Hill	County: York	State: SC	ZipCode: 29730	
Owner:				
:				
Measurer: Square Up Measuring		Inspection Date: 07/09/2024		

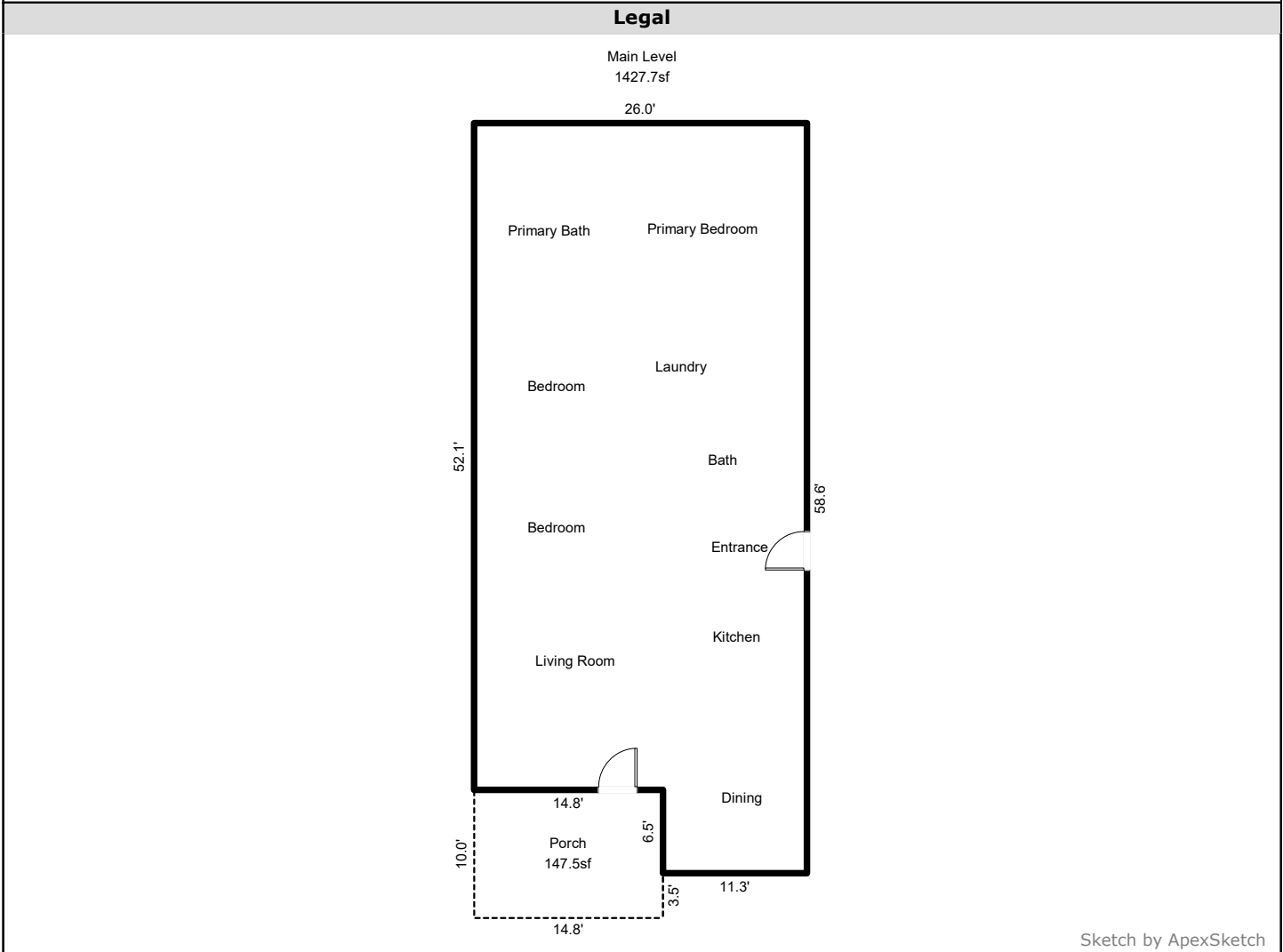

AREA CALCULATIONS SUMMARY						COMMENT TABLE 1			
Code	Description	Factor	Net Size	Perimeter	Net Totals				
GLA1	Main Level	1.0	1427.7	169.2	1427.7	For a more accurate measurement, measurements are based on the Official ANSI Z765-2021 Handbook and the current North Carolina Residential Square Footage Guideline approved by the American National Standards Institute (ANSI) and recognized by the North Carolina Real Estate Commission for single-family dwellings, townhouses and condos for both North and South Carolina. Measurements for marketing and informational purposes.			
P/P	Porch	1.0	147.5	49.5	147.5				
Net LIVABLE						cnt	1	(rounded)	1,428
						COMMENT TABLE 2	COMMENT TABLE 3		

Property Measurements

Parcel

Legal: Parcel No.:
Property Address: 220 High St
City: Rock Hill County: York State: SC ZipCode: 29730
Owner:
:
Measurer: Square Up Measuring Inspection Date: 07/09/2024

Legal

Main Level (GLA1)

58.60 x 11.25 = 659.25
52.10 x 14.75 = 768.48
Total area: 1427.73

Porch (P/P)

14.75 x 6.50 = 95.87
14.75 x 3.50 = 51.63
Total area: 147.50