

Property Measurements

Parcel					
Legal:	Parcel No.:				
Property Address: 7429 Boswell Rd					
City: Charlotte	County: Mecklenburg	State: NC	ZipCode: 28215		
Owner:					
:					
Measurer: Square Up Measuring			Inspection Date: 07/12/2024		

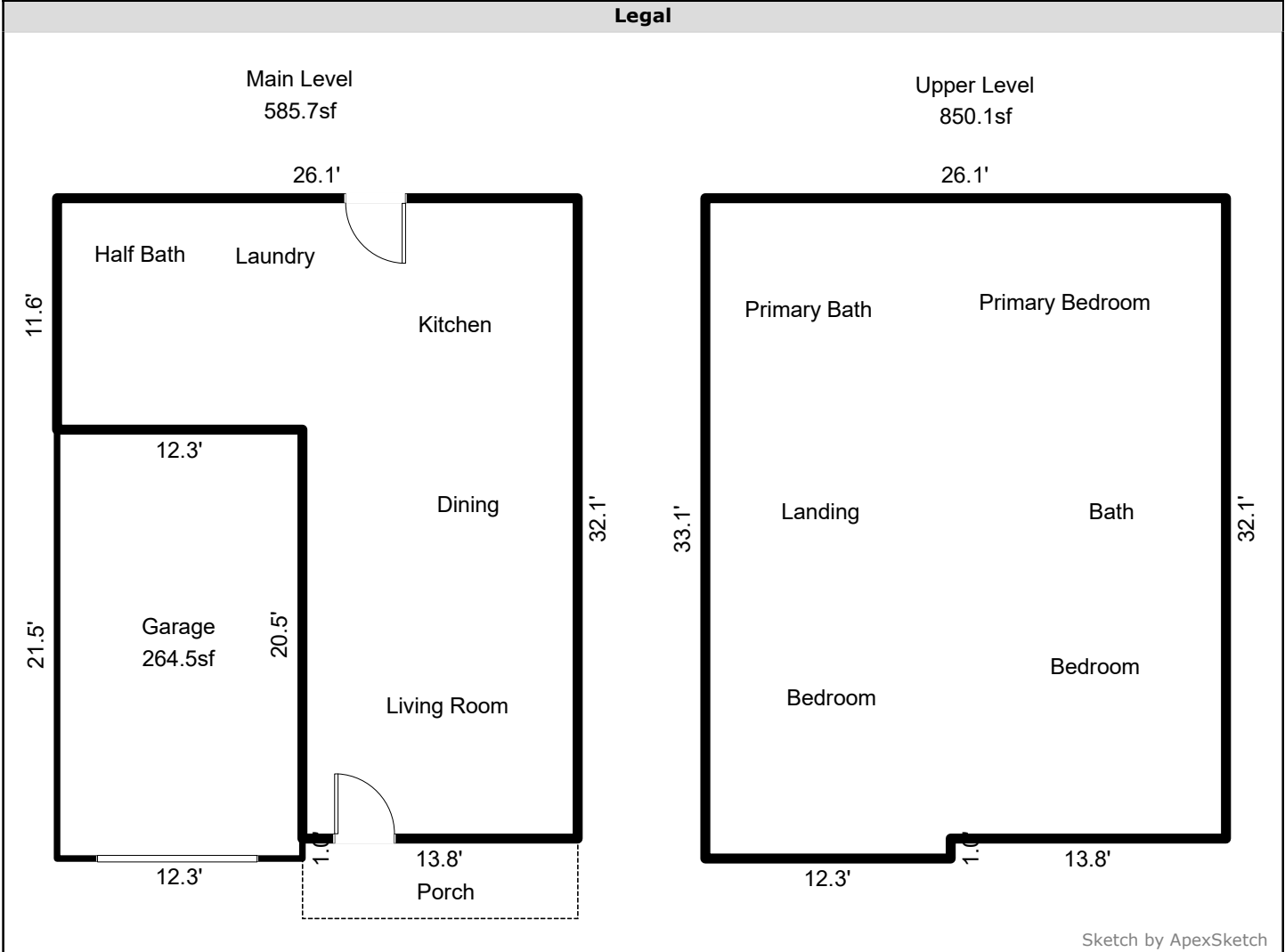

AREA CALCULATIONS SUMMARY											
Code	Description	Factor	Net Size	Perimeter	Net Totals						
GLA1	Main Level	1.0	585.7	116.4	585.7						
GLA2	Upper Level	1.0	850.1	118.4	850.1						
GAR	Garage	1.0	264.5	67.6	264.5						
<table style="width: 100%; border: none;"> <tr> <td style="width: 20%;"></td> <td style="width: 10%; text-align: center;">cnt</td> <td style="width: 10%; text-align: center;">2</td> <td style="width: 20%; text-align: center;">(rounded)</td> <td style="width: 10%;"></td> <td style="width: 20%; text-align: center;">1,436</td> </tr> </table>							cnt	2	(rounded)		1,436
	cnt	2	(rounded)		1,436						

COMMENT TABLE 1	
<p>For a more accurate measurement, measurements are based on the Official ANSI Z765-2021 Handbook and the current North Carolina Residential Square Footage Guideline approved by the American National Standards Institute (ANSI) and recognized by the North Carolina Real Estate Commission for single-family dwellings, townhouses and condos for both North and South Carolina. Measurements for marketing and informational purposes.</p> <ul style="list-style-type: none"> Doors, stairs and fireplace locations are approximate. Room locations are approximate. All measurements are rounded to the nearest tenth of an inch. 	
COMMENT TABLE 2	COMMENT TABLE 3

Property Measurements

Parcel

Legal: Parcel No.:
Property Address: 7429 Boswell Rd
City: Charlotte County: Mecklenburg State: NC ZipCode: 28215
Owner:
:
Measurer: Square Up Measuring Inspection Date: 07/12/2024

Legal

Main Level (GLA1)

$$32.10 \times 13.80 = 442.98$$

$$12.30 \times 11.60 = 142.68$$

$$\text{Total area: } 585.66$$

Upper Level (GLA2)

$$33.10 \times 12.30 = 407.13$$

$$32.10 \times 13.80 = 442.98$$

$$\text{Total area: } 850.11$$

Garage (GAR)

$$21.50 \times 12.30 = 264.45$$

$$\text{Total area: } 264.45$$