

# Property Measurements

Parcel				
Legal:	Parcel No.:			
Property Address: 57 Pinckney St				
City: York	County: York	State: SC	ZipCode: 29745	
Owner:				
:				
Measurer: Square Up Measuring		Inspection Date: 07/19/2024		

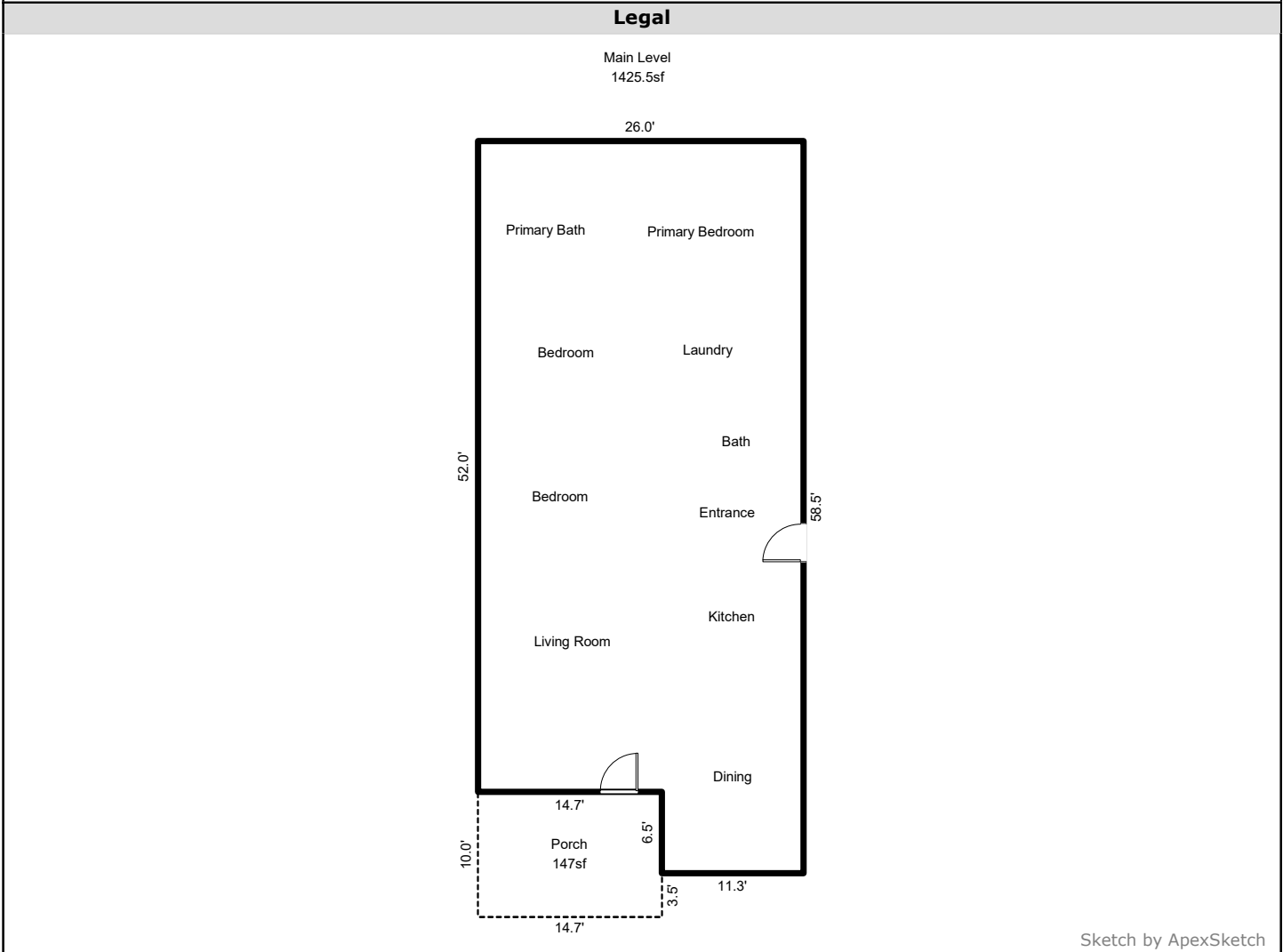

AREA CALCULATIONS SUMMARY						COMMENT TABLE 1
Code	Description	Factor	Net Size	Perimeter	Net Totals	
GLA1	Main Level	1.0	1425.5	169.0	1425.5	For a more accurate measurement, measurements are based on the Official ANSI Z765-2021 Handbook and the current North Carolina Residential Square Footage Guideline approved by the American National Standards Institute (ANSI) and recognized by the North Carolina Real Estate Commission for single-family dwellings, townhouses and condos for both North and South Carolina. Measurements for marketing and informational purposes.
P/P	Porch	1.0	147.0	49.4	147.0	
<b>Net LIVABLE</b> cnt      1      (rounded)      1,425						<div style="background-color: #cccccc; padding: 5px; margin-bottom: 5px;"><b>COMMENT TABLE 2</b></div> <div style="background-color: #cccccc; padding: 5px; margin-bottom: 5px;"><b>COMMENT TABLE 3</b></div>

# Property Measurements

## Parcel

Legal: Parcel No.:  
Property Address: 57 Pinckney St  
City: York County: York State: SC ZipCode: 29745  
Owner:  
:  
Measurer: Square Up Measuring Inspection Date: 07/19/2024

## Legal

### Main Level (GLA1)

58.50 x 11.30 = 661.05  
52.00 x 14.70 = 764.40  
Total area: 1425.45

### Porch (P/P)

14.70 x 6.50 = 95.55  
14.70 x 3.50 = 51.45  
Total area: 147.00