

Property Measurements

Parcel				
Legal:	Parcel No.:			
Property Address: 2177 Minthaw Circle				
City: Lincolnton	County: Lincoln	State: NC	ZipCode: 28092	
Owner:				
:				
Measurer: Square Up Measuring		Inspection Date: 07/15/2024		

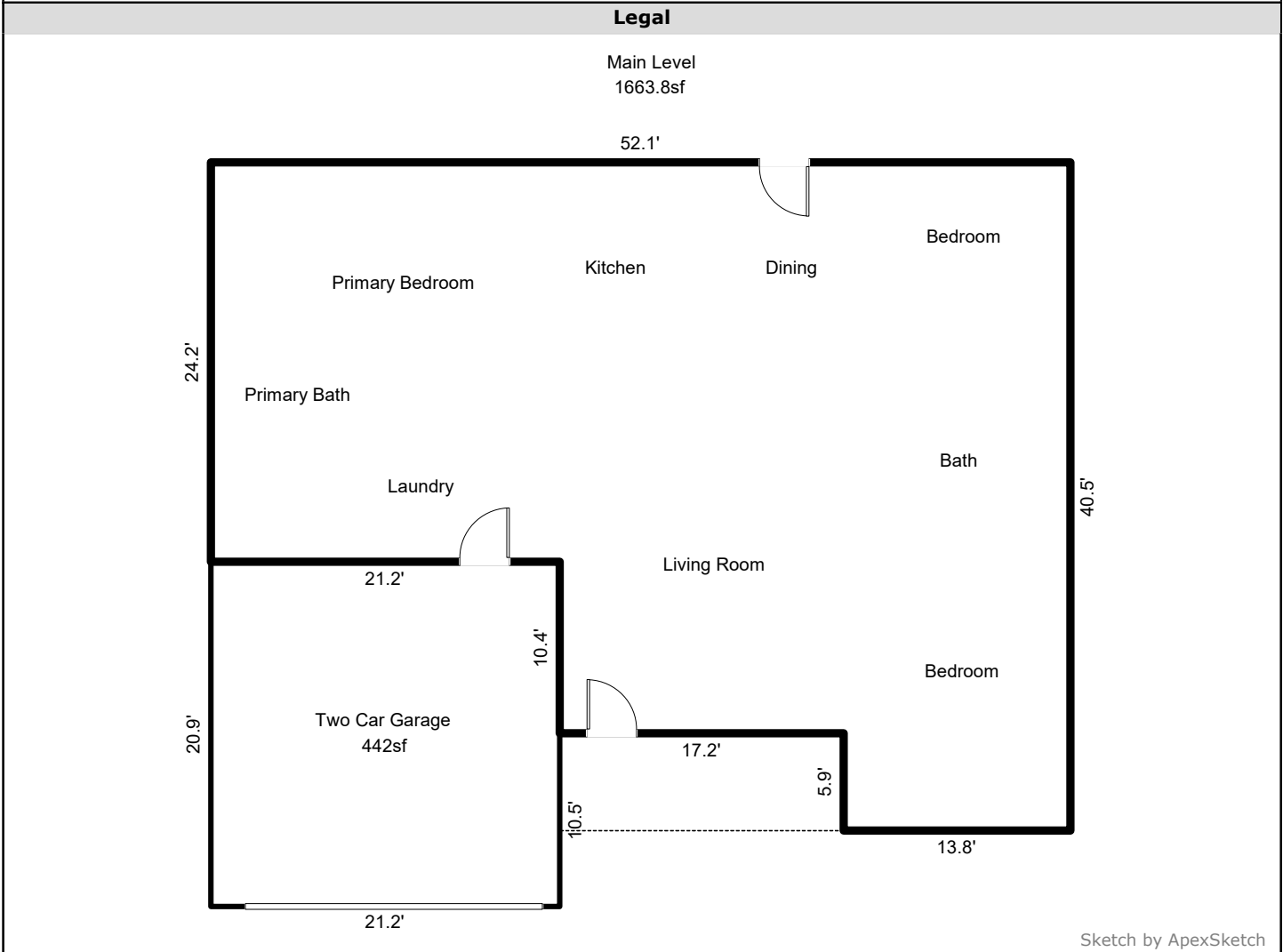

AREA CALCULATIONS SUMMARY						COMMENT TABLE 1							
Code	Description	Factor	Net Size	Perimeter	Net Totals	For a more accurate measurement, measurements are based on the Official ANSI Z765-2021 Handbook and the current North Carolina Residential Square Footage Guideline approved by the American National Standards Institute (ANSI) and recognized by the North Carolina Real Estate Commission for single-family dwellings, townhouses and condos for both North and South Carolina. Measurements for marketing and informational purposes. <ul style="list-style-type: none"> Doors, stairs and fireplace locations are approximate. Room locations are approximate. All measurements are rounded to the nearest tenth of an inch. <div style="text-align: right; font-size: small;"> </div>							
GLA1	Main Level	1.0	1663.8	185.2	1663.8								
GAR	Two Car Garage	1.0	442.0	84.1	442.0								
						COMMENT TABLE 2	COMMENT TABLE 3						
<table style="width: 100%; border-collapse: collapse;"> <tr> <td style="width: 20%; text-align: right;">Net LIVABLE</td> <td style="width: 10%;">cnt</td> <td style="width: 10%; text-align: center;">1</td> <td style="width: 10%;">(rounded)</td> <td style="width: 10%;"></td> <td style="width: 10%; text-align: right;">1,664</td> </tr> </table>						Net LIVABLE	cnt	1	(rounded)		1,664		
Net LIVABLE	cnt	1	(rounded)		1,664								

Property Measurements

Parcel

Legal: Parcel No.:
Property Address: 2177 Minthew Circle
City: Lincolnton County: Lincoln State: NC ZipCode: 28092
Owner:
:
Measurer: Square Up Measuring Inspection Date: 07/15/2024

Legal

Main Level (GLA1)

34.60 x 30.95 = 1070.87
13.75 x 5.90 = 81.13
24.20 x 21.15 = 511.83
Total area: 1663.83

Two Car Garage (GAR)

21.15 x 10.40 = 219.96
21.15 x 10.50 = 222.08
Total area: 442.04