

# Property Measurements

Parcel				
Legal:	Parcel No.:			
Property Address: 1112 Smith St				
City: Rock Hill	County: York	State: SC	ZipCode: 29732	
Owner:				
:				
Measurer: Square Up Measuring		Inspection Date: 07/16/2024		

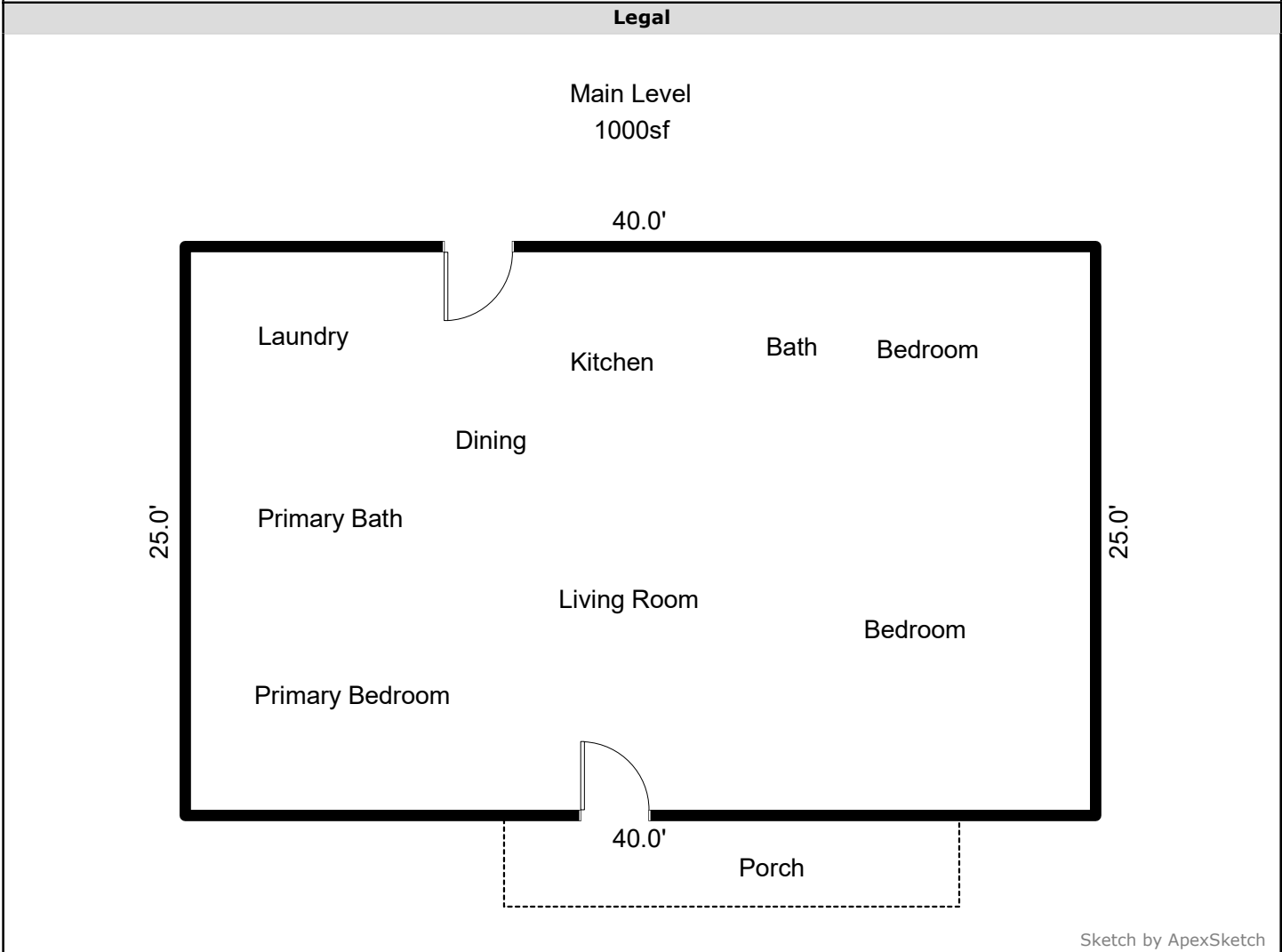

AREA CALCULATIONS SUMMARY						COMMENT TABLE 1	
Code	Description	Factor	Net Size	Perimeter	Net Totals		
GLA1	Main Level	1.0	1000.0	130.0	1000.0	<p>For a more accurate measurement, measurements are based on the Official ANSI Z765-2021 Handbook and the current North Carolina Residential Square Footage Guideline approved by the American National Standards Institute (ANSI) and recognized by the North Carolina Real Estate Commission for single-family dwellings, townhouses and condos for both North and South Carolina. Measurements for marketing and informational purposes.</p> <ul style="list-style-type: none"> <li>Doors, stairs and fireplace locations are approximate.</li> <li>Room locations are approximate.</li> <li>All measurements are rounded to the nearest tenth of an inch.</li> </ul> <div style="text-align: right;"> </div>	
<p style="text-align: right;">Net LIVABLE                      cnt                      1      (rounded)                      1,000</p>							
						COMMENT TABLE 2	COMMENT TABLE 3

# Property Measurements

## Parcel

Legal: Parcel No.:

Property Address: 1112 Smith St

City: Rock Hill

County: York

State: SC

ZipCode: 29732

Owner:

: :

Measurer: Square Up Measuring

Inspection Date: 07/16/2024

## Legal

Main Level (GLA1)

40.00 x 25.00 = 1000.00

Total area: 1000.00