

Property Measurements

Parcel				
Legal:	Parcel No.:			
Property Address: 333 Red Chimney Rd				
City: Statesville	County: Iredell	State: NC	ZipCode: 28625	
Owner:				
:				
Measurer: Square Up Measuring		Inspection Date: 09/14/2024		

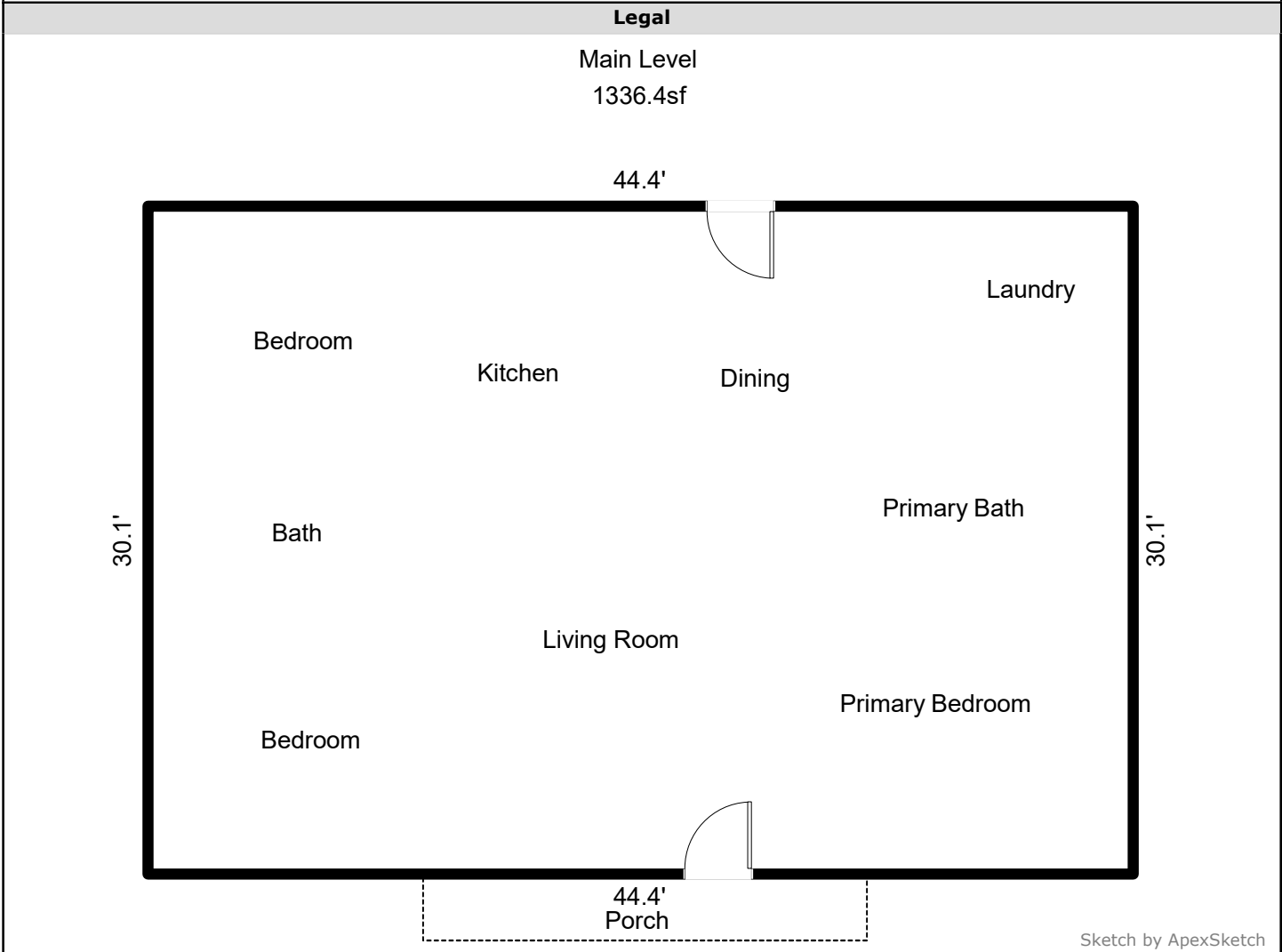

AREA CALCULATIONS SUMMARY						COMMENT TABLE 1	
Code	Description	Factor	Net Size	Perimeter	Net Totals		
GLA1	Main Level	1.0	1336.4	149.0	1336.4	<p>For a more accurate measurement, measurements are based on the Official ANSI Z765-2021 Handbook and the current North Carolina Residential Square Footage Guideline approved by the American National Standards Institute (ANSI) and recognized by the North Carolina Real Estate Commission for single-family dwellings, townhouses and condos for both North and South Carolina. Measurements for marketing and informational purposes.</p> <ul style="list-style-type: none"> Doors, stairs and fireplace locations are approximate. Room locations are approximate. All measurements are rounded to the nearest tenth of an inch. 	
	Net LIVABLE	cnt	1	(rounded)	1,336		
						COMMENT TABLE 2	COMMENT TABLE 3

Property Measurements

Parcel

Legal: Parcel No.:
Property Address: 333 Red Chimney Rd
City: Statesville County: Iredell State: NC ZipCode: 28625
Owner:
:
Measurer: Square Up Measuring Inspection Date: 09/14/2024

Legal

Main Level (GLA1)
44.40 x 30.10 = 1336.44
Total area: 1336.44